



PU570/PU572

Pure Cube Indoor Sauna Assembly Instructions



*Shown with optional semi privacy panel

Requirements:

2 People (recommended)
 Rubber Mallet
 Carpenters Hammer
 Carpenters Level
 Carpenters Square
 Tape Measure
 Cordless Drill

Staple Gun
 1 ¼" Staples
 Step Ladder
 Utility Knife
 Drill Bit set
 2" hole Saw

It is highly recommended to view the assembly video prior to starting assembly!

[Click here to View the assembly process or scan the QR code.](#)





PU570/PU572 Pure Cube Indoor Sauna Assembly Instructions

*Before you begin the installation of your Pure Cube Sauna,
Please read these instructions completely.*

Index

Sauna Assembly

Bench Assembly

Electric Heater Installation

Vent Kit Installation

Care & Maintenance

Warranty

Manufactured by:



tel: 888-923-9813 | info@leisurecraft.com | web: www.leisurecraft.com

PU570/PU572 Pure Cube Indoor Sauna Assembly Instructions

Sauna Assembly



Organize the pieces of your Pure Cube sauna.

Place a wide wall panel and a corner post flush together.



Secure the post to the wide panel using the provided 2 3/4" (70mm) Connector Lag Bolts.

Use a 5/32" drill bit to predrill the holes.

The walls should be assembled so the screws and bolts should be on the outside of the sauna.

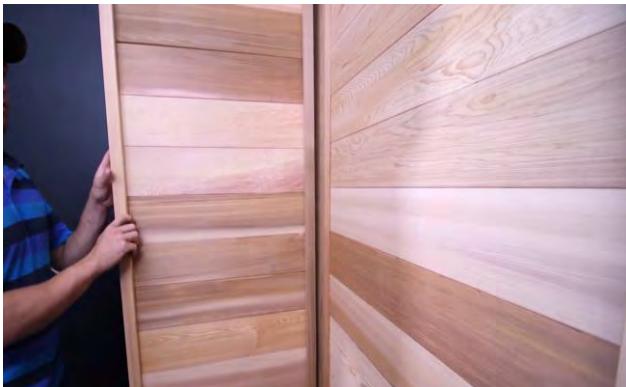

Secure a narrow panel to the corner post in the same manner to make the sauna corner.

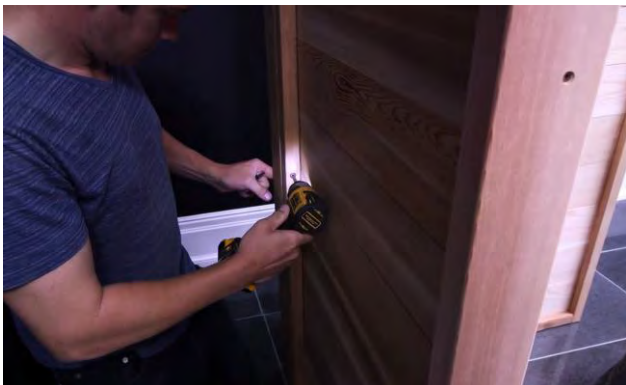

Secure the panel to the post using the provided 2 3/4" (70mm) Connector Lag screws in the same manner as the previous panel using a 5/32" drill bit to predrill the holes.

Manufactured by:

PU570/PU572 Pure Cube Indoor Sauna Assembly Instructions

Sauna Assembly



Connect a narrow panel to the wide panel using 2 ¾" (70mm) connector bolts and a connector cap nut.

Using the provided hex keys, snug up all the bolts.



Fasten a narrow panel to narrow panel on the back wall using 2 ¾" (70mm) connector bolts and a connector cap nut in the same manner as the last step.



Repeat the process with a narrow panel on the back wall.



Place a corner post flush to the last narrow panel ensuring they are flush, then Secure the wall panel to the post using the 2 ¾" (70mm) Connector lag screws through the predrilled holes.

Use a 5/32" drill bit to predrill the holes.

Manufactured by:



tel: 888-923-9813 | info@leisurecraft.com | web: www.leisurecraft.com

PU570/PU572 Pure Cube Indoor Sauna Assembly Instructions

Sauna Assembly



Now fasten a wide panel to the post and a narrow panel to the wide panel in the same manner as the previous steps.



At the front corner, attach a corner post to the narrow panel by securing the wall panel to the post using the 2 ¾" (70mm) Connector lag screws through the predrilled holes.

Use a 5/32" drill bit to predrill the holes.



Place one of the glass panels flush to the corner post and secure with the 2 ¾" (70mm) Connector lag screws through the predrilled holes.

This could be either a full glass panel or semi privacy panel depending on the panel ordered.

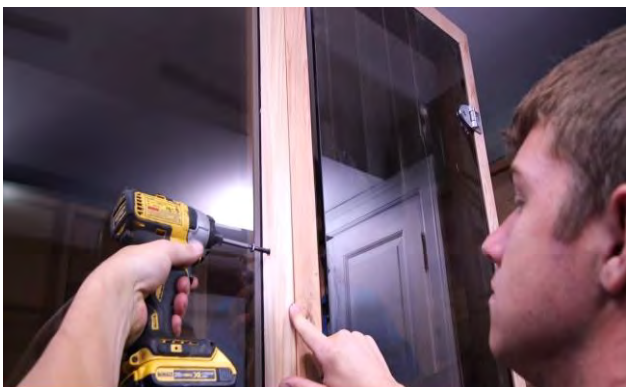

Place your glass door flush to the glass panel.

Ensure the door opens outward and the hinges are on the side you want.

Secure the panel to the door with the 2 ¾" (70mm) Connector lag screws through the predrilled holes.

Manufactured by:

PU570/PU572 Pure Cube Indoor Sauna Assembly Instructions

Sauna Assembly



Repeat for the last panel on the front of the sauna.

Again, this could be either a full glass panel or semi privacy panel depending on the panel ordered.



Attach the last corner post to the glass panel and the narrow panel on the side wall by securing both panels to the post using the 2 3/4" (70mm) Connector lag screws through the predrilled holes.

Use a 5/32" drill bit to predrill the holes.



Place the 2 roof panels on top of the sauna.

Ensure the roof panels are flush to the walls.

To make the next steps easier, line the panels up as close as possible to each other.



Inside, line up the holes and fasten the roof panels together with 2 3/4" (70mm) connector bolts and cap nuts.

When you have the roof panels connected, tighten up the bolts with a drill and hex key.

Manufactured by:

PU570/PU572 Pure Cube Indoor Sauna Assembly Instructions

Sauna Assembly



Ensure the roof panels are still flush to the walls and secure the wall panels to the roof panels using 2 ½" (64mm) screws.

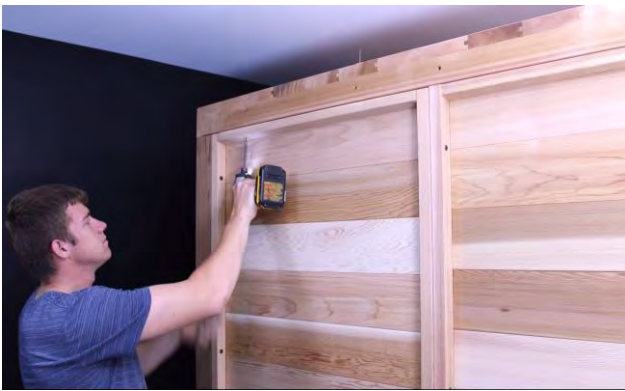

Continue around the sauna securing all the wall panels to the roof using 2 - 2 ½" (64mm) screws per panel.



Line up one of the side trim pieces flush to the front of the sauna so that it sits ¾" (19mm) below the joint of the roof and the wall panels.



Secure the side trim piece from the inside of the sauna using the 2 ¾" (70mm) connector lag bolts through the predrilled holes.

Use a 5/32" drill bit to predrill the holes.

Make sure not to drill completely through the side trim piece.

Manufactured by:

Repeat for the side roof trim on the opposite side.

PU570/PU572 Pure Cube Indoor Sauna Assembly Instructions

Sauna Assembly



Repeat the process for the front and back roof trim.



Install the door handle by placing the provided 2" (50mm) lag screws through the inner handle (short) into the outer handle (longer)

Use the hex key to snug up, do not tighten all the way.



Ensure the outer handle lines up with the magnetic catch on the door frame and then tighten the lag screws completely.

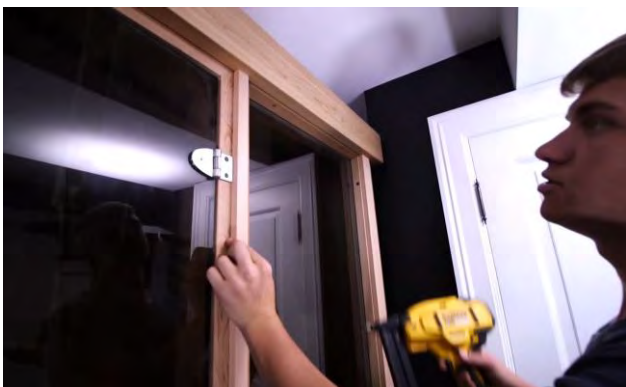

Secure the 2 door trim pieces (narrow trim) over the seams beside the door using staples or finishing nails.

Repeat the process with the wall trim pieces (wide trim) over the rest of the seams around the sauna.

Manufactured by:



tel: 888-923-9813 | info@leisurecraft.com | web: www.leisurecraft.com

PU570/PU572 Pure Cube Indoor Sauna Assembly Instructions

Bench Assembly



Bring in your bench supports and place 1 support at either end of the back wall.



Ensure the bench support is tight to the side and back walls, then secure the support to the walls using 2 ½" (64mm) screws.

Repeat on opposite end.



Bring in the top bench and place it on top of the bench supports.

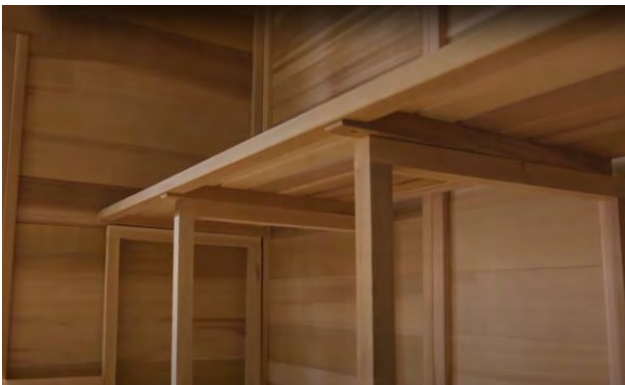

Line up the remaining bench supports with the braces on the bottom of the top bench.

Manufactured by:

PU570/PU572 Pure Cube Indoor Sauna Assembly Instructions

Bench Assembly



Secure the bench supports to the top bench from underneath using 2 ½" (64mm) screws.



Ensure the bench supports are square and secure to the back wall 2 ½" (64mm) screws.



Ensure the backrest is level and secure the backrest to the back wall by screwing it in between the slats using 2 ½" (64mm) screws.

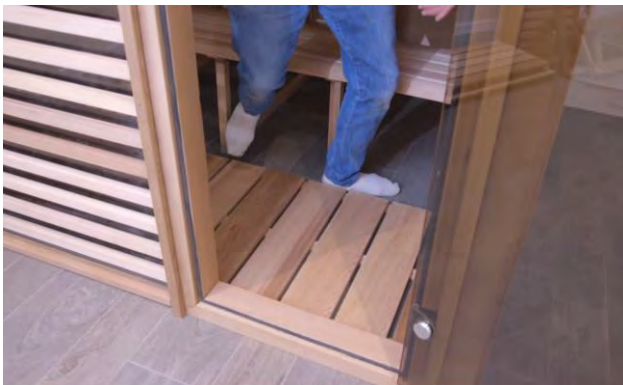

Gently lay the duckboard floor in front of the bench.

Manufactured by:

PU570/PU572 Pure Cube Indoor Sauna Assembly Instructions

Bench Assembly



Line up the lower front bench enclosure with the bench supports.



Secure the lower front bench enclosure to the bench supports by screwing between the slats using 2 ½" (64mm) screws.



Repeat for top front bench enclosure.

Manufactured by:

PU570/PU572 Pure Cube Indoor Sauna Assembly Instructions

Electric Heater Installation



To start the installation of the electric heater, measure the width of the stove mounting holes.



Measure the height of the mounting holes and add 6" (152mm).



Transfer the measurements to the side wall of the sauna where the heater will be placed.

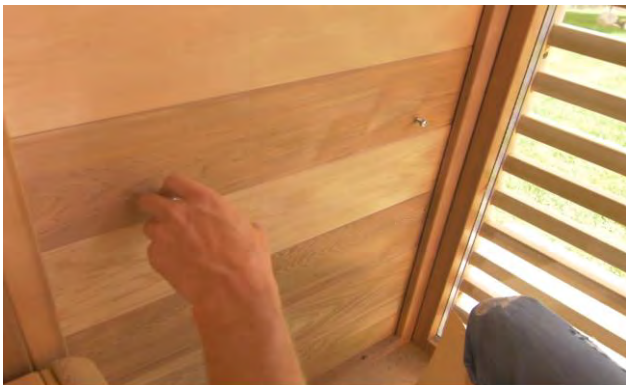

Install the supplied support screws into your marks as shown.

Screw them in until they are about ¼" (6mm) out of the wall.

Manufactured by:

PU570/PU572 Pure Cube Indoor Sauna Assembly Instructions

Electric Heater Installation (Optional)



Hang the electric heater on the screws.

Screw 2 more screws in the bottom holes of the heater and once the heater is level, you can tighten up all 4 screws.

Place Rocks in heater as per heater instructions.



Locate the pieces for your heater guard.

Stand the 2 Assembled side pieces of the heater guard on edge with pre-drilled holes on the bottom.



Screw heater guard support to either side using (2) – 1 ½" (38mm) screws per side.

Repeat for the bottom heater guard support.



Place 2- 2 ½" (64mm) screws into the pre-drilled holes on either side of heater guard to prepare for mounting.

Manufactured by:

PU570/PU572 Pure Cube Indoor Sauna Assembly Instructions

Electric Heater Installation (Optional)



Center the guard around the heater and secure to wall with the preplaced screws.

Ensure the guard is level and secure the other side.



Wash the layer of rock dust off of the sauna rocks before using them.

When your sauna is set up and working you should “break-in” the sauna before using it for the first time by turning on the heater to its highest setting and operate it for about 1 hour.

This is recommended to burn off any oils impurities from manufacturing, and it also “cures” the woodwork.

- *All wiring should be installed according to the heater manufacturers instructions and by a licensed electrician.*

- **Do NOT use a G.F.I breaker**

Manufactured by:

PU570/PU572 Pure Cube Indoor Sauna Assembly Instructions

Vent Installation (Optional)

In most cases, venting is not required for proper sauna function, however it increases air flow circulation as well as ventilation when the sauna is not in use.

Many people prefer not to install vents in prefabricated saunas.

Generally, you have access to add a vent to your sauna once assembled if it is deemed necessary.

Vent Kit Contents

Stainless Steel 3"x 7" Grill (X2)
Cedar Vent Cover
1 ½" Stainless Steel screws
(X13)



The Location of the vent depends on the type of sauna purchased and the location of the heater. Use the following instructions as a guide to help you determine where the vent should be located.

Inlet – Low below heater

Outlet – High up at far corner away from heater

Ex. Saunas with the heater on the back wall in the middle, the inlet would go under heater on the back wall and the outlet would go high on the front wall.

Saunas with the heater on the front wall would have the inlet under the heater on the front wall and the outlet high on the back wall for maximum airflow.

For Saunas with wood heaters, get the inlet as close as possible to the wood heater and the outlet high in the opposite corner.



Inlet holes drilled under electric heater on side wall



Outlet vent high on opposite wall of heater.

Manufactured by:



tel: 888-923-9813 | info@leisurecraft.com | web: www.leisurecraft.com

PU570/PU572 Pure Cube Indoor Sauna Assembly Instructions

Vent Installation (Optional)



Drill inlet holes with a 2" (51mm) hole saw under the heater close to the floor.

Only go halfway through to prevent splintering and drill the remainder from the other side of wall.

A 2" (51mm) diameter hole was used in pictures but more holes with a smaller drill size will also work)



Install 1 of the stainless-steel vent grills over the inlet holes on the outside of the sauna centered over the holes using 6 - 1 ½" (38mm) screws.



On the wall opposite the heater, close to the top, drill the outlet holes in the same manner as the previous step.

Install the cedar vent cover over the outlet holes on the inside of the sauna with a 1 ½" screw tightening the screw enough that the vent cover still rotates smoothly.



Install the other stainless-steel vent grill centered over the holes on the outside of the sauna using 6 - 1 ½" (38mm) screws.

Manufactured by:

MAINTAINING YOUR SAUNA AFTER INSTALLATION

Interior

It is recommended to vacuum or sweep out the inside of your sauna frequently to remove dirt and other debris.

Under normal conditions, a slight wash of the floor and benches with warm soapy water several times a year will maintain its cleanliness. You can use a sheet of fine grit sandpaper or a low pressure wash to remove more stubborn stains or for a deeper cleaning of the interior of your sauna.

Never use ammonia or harsh cleaners as they can turn the wood gray.

Exterior

Depending on the humidity and weather conditions in your area, the cedar will either shrink or expand based on the amount of moisture absorption. The desired effect is to have the cedar expand into the bands therefore making the sauna staves much tighter.

Over time the lumber will weather naturally as a result of sun and rain, it will change into a weathered grey colour. This natural weathering will not harm the wood or impair the sauna's performance.

If you wish to retain the natural color of your Dundalk Leisurecraft Sauna, there are many cedar stains on the market and almost as many opinions as to which is best.

We encourage you to rely on your own research and referrals.

Recommended Stains Include:

Behr Premium Semi-Transparent Waterproofing Stain & Sealer

Sikkens Proluxe Cetol SRD Translucent Stain

<https://www.realcedar.com/outdoor/finishing-choices/>

Note: never treat the interior of the Sauna, and never apply paint or varnish to the exterior.



Water Seepage

Some minor water seeping into the sauna is expected and normal for an outdoor sauna.

If your sauna is properly installed, you should not have water dripping in but you should expect some water seepage, especially on the top and sides of the sauna.

This is due to the porous characteristics of the wood and to the ball-and-socket profile design of the staves. Water Seepage will not harm the sauna. The moisture will evaporate once you turn on the heater and the sauna heats up.

If the water marks are bothersome, they can be easily removed with a light sanding (80 or 100 grit)



HOW TO TAKE A SAUNA

1. Pre-heat your sauna to the desired temperature (usually between 80-100°C)
2. While it's warming up, take a nice hot shower.
3. Enter the pre-heated sauna, relax and allow your body to perspire in the soft dry heat. Do not throw water on the rocks during the first part of the session.
4. Cool off with a cold shower or a quick swim in a lake or pool.
5. Re-enter the sauna and sprinkle water on the rocks. This will increase humidity to assist in perspiration. Half a cup every 5 minutes should be enough. Too much water will just cool off the rocks and you'll get less steam.
6. After a 20-30 minute sauna, cool off in the shower or lake or pool.
7. Repeat this sauna/cold shower process as often as desired.
8. After each use, leave the door fully open for a few hours if possible so the wood can dry out.

**These are guidelines only. Enjoy your sauna in whichever way you desire.
Children must be supervised by an adult.**

WARRANTY

LeisureCraft warrants our saunas against defects in materials and workmanship under normal/residential use for a period of five (5) years, as applicable, from the date of receipt of the product by the original end-user consumer. This warranty does not apply to normal wear and tear and/or natural weather conditions. This warranty does not cover regular required maintenance of the sauna, (eg. Tightening bands on the barrels, cleaning or staining the sauna) refer to your sauna assembly manual for maintenance guidelines. This warranty does not cover misuse or negligence and the manufacturer and associated retailers are not liable for any injury or damage caused by the product. This warranty is a parts only warranty and any service or labor costs would not be considered as part of the 5 year warranty.

Purchaser Name: _____ Date: _____

Purchased From: _____

Manufactured by:



tel: 888-923-9813 | info@leisurecraft.com | web: www.leisurecraft.com